



DC-鼓风机风扇 30x30x07mm

马达可选功能列表 (Available Functions)

1. 马达保护 (Moto protection)

AS

2. 信号输出 (Signal out put)

FG

RD

3. 调速方式 (Speed control mode)

PWM

TC



风扇单重: 9g (weight: 9g)



DC BLOWER FAN
鼓风机风扇

风扇P-Q曲线 / Fan performance curve

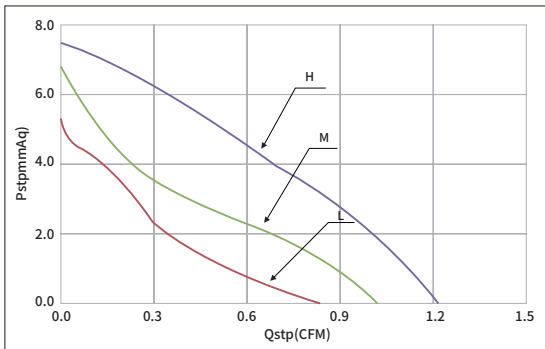

尺寸图 / DIMENSIONS DRAWING

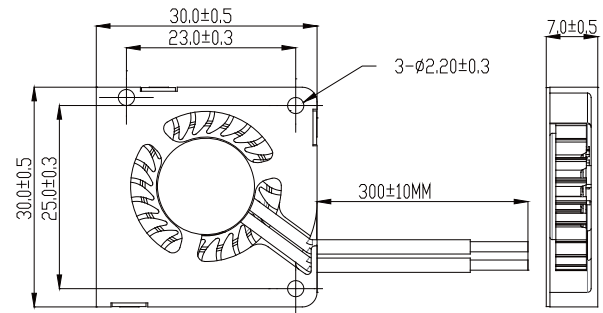

| Model | Bearing | Rated Voltage | Startup Voltage | Current | Power | Speed | Air Flow | Static Pressure | Noise | | | |
|-----------|-----------|---------------|-----------------|---------|-------|-------|----------|---------------------|-------|--------------------|--------------------|-------|
| 型号 | 轴承 | 工作电压 | 启动电压 | 电流 | 功率 | 转速 | 风量 | 风压 | 噪音 | | | |
| Part NO. | Function | System | VDC | VDC | A | W | RPM | M ³ /min | CFM | mmH ₂ O | INH ₂ O | dB(A) |
| HBH0305HQ | Hydraulic | 5 | | 4.0 | 0.16 | 0.80 | 8500 | 0.03 | 1.22 | 7.52 | 0.30 | 28.4 |
| HBH0305MQ | | | | 4.0 | 0.14 | 0.70 | 7500 | 0.03 | 1.02 | 6.84 | 0.27 | 25.8 |
| HBH0305LQ | | | | 4.0 | 0.10 | 0.50 | 5500 | 0.02 | 0.84 | 5.73 | 0.23 | 22.7 |
| HBH0312HQ | Hydraulic | 12 | | 6.0 | 0.06 | 0.72 | 8500 | 0.03 | 1.22 | 7.52 | 0.30 | 28.4 |
| HBH0312MQ | | | | 6.0 | 0.05 | 0.60 | 7500 | 0.03 | 1.02 | 6.84 | 0.27 | 25.8 |
| HBH0312LQ | | | | 6.0 | 0.03 | 0.36 | 5500 | 0.02 | 0.84 | 5.73 | 0.23 | 22.7 |

提示1: 目录首页有功能的详细信息。 Notes1: The catalog have detail information in the front page for the functions.

提示2: 如果您需要列表中的其他转速或电压或功能, 请与我们的业务联系。 Notes2: If you need other speed or voltage or function in the list, please contact our business.