



DC-直流轴流风扇 60x60x20mm

马达可选功能列表 (Available Functions)

1. 马达保护 (Moto protection)

AS

2. 信号输出 (Signal out put)

FG

RD

3. 调速方式 (Speed control mode)

PWM



风扇单重: 51g (weight: 51g)



风扇P-Q曲线 / Fan performance curve

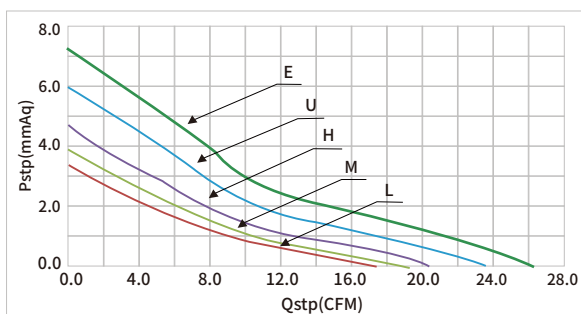

尺寸图 / DIMENSIONS DRAWING

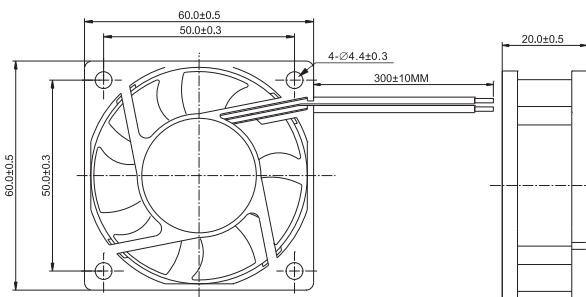

Model		Bearing	Rated Voltage	Startup Voltage	Current	Power	Speed	Air Flow		Static Pressure		Noise
型号		轴承	工作电压	启动电压	电流	功率	转速	风量		风压		噪音
Part NO.	Function	System	VDC	VDC	A	W	RPM	M ³ /min	CFM	mmH ₂ O	INH ₂ O	dB(A)
HDH0605MC	-A	Hydraulic	5	4.00	0.33	1.65	4000	0.55	19.30	3.88	0.15	27.3
HDH0605LC				4.00	0.28	1.40	3500	0.49	17.38	3.34	0.13	23.4
HDB0605MC	-A	Ball		4.00	0.33	1.65	4000	0.55	19.30	3.88	0.15	27.3
HDB0605LC				4.00	0.28	1.40	3500	0.49	17.38	3.34	0.13	23.4
HDH0612EC		Hydraulic	12	6.00	0.27	3.24	5500	0.74	26.30	7.21	0.28	35.2
HDH0612UC				6.00	0.23	2.76	5000	0.67	23.69	5.93	0.23	32.9
HDH0612HC				6.00	0.18	2.16	4500	0.58	20.44	4.67	0.18	30.6
HDH0612MC				6.00	0.15	1.80	4000	0.55	19.30	3.88	0.15	27.3
HDH0612LC		Ball		6.00	0.12	1.44	3500	0.49	17.38	3.34	0.13	23.4
HDB0612EC				6.00	0.27	3.24	5500	0.74	26.30	7.21	0.28	35.2
HDB0612UC				6.00	0.23	2.76	5000	0.67	23.69	5.93	0.23	32.9
HDB0612HC				6.00	0.18	2.16	4500	0.58	20.44	4.67	0.18	30.6
HDB0612MC		Hydraulic	24	6.00	0.15	1.80	4000	0.55	19.30	3.88	0.15	27.3
HDB0612LC				6.00	0.12	1.44	3500	0.49	17.38	3.34	0.13	23.4
HDH0624HC				12.00	0.15	3.60	4500	0.58	20.44	4.67	0.18	30.6
HDH0624MC				12.00	0.09	2.16	4000	0.55	19.30	3.88	0.15	27.3
HDH0624LC		Ball		12.00	0.07	1.68	3500	0.49	17.38	3.34	0.13	23.4
HDB0624EC				12.00	0.27	3.24	5500	0.74	26.30	7.21	0.28	35.2
HDB0624UC				12.00	0.23	2.76	5000	0.67	23.69	5.93	0.23	32.9
HDB0624HC				12.00	0.18	2.16	4500	0.58	20.44	4.67	0.18	30.6
HDB0624MC		Hydraulic	24	12.00	0.09	2.16	4000	0.55	19.30	3.88	0.15	27.3
HDB0624LC				12.00	0.07	1.68	3500	0.49	17.38	3.34	0.13	23.4